

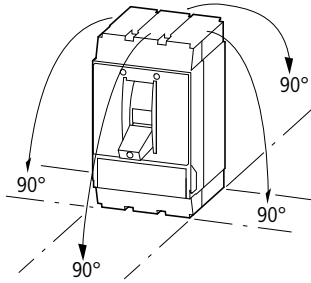

01/11 IL01206012Z  
(AWA1230-2381)

Instruction Leaflet  
Montageanweisung  
Notice d'installation  
Instrucciones de montaje  
Istruzioni per il montaggio  
安装说明  
Инструкция по монтажу

**LZMB(C)(N)(S)2(-4)-A(ASF)(S)...  
LN2**



**(en) Electric current! Danger to life!**

Only skilled or instructed persons may carry out the following operations.

**(de) Lebensgefahr durch elektrischen Strom!**

Nur Elektrofachkräfte und elektrotechnisch unterwiesene Personen dürfen die im Folgenden beschriebenen Arbeiten ausführen.

**(fr) Tension électrique dangereuse !**

Seules les personnes qualifiées et averties doivent exécuter les travaux ci-après.

**(es) ¡Corriente eléctrica! ¡Peligro de muerte!**

El trabajo a continuación descrito debe ser realizado por personas cualificadas y advertidas.

**(it) Tensione elettrica: Pericolo di morte!**

Solo persone abilitate e qualificate possono eseguire le operazioni di seguito riportate.

**(zh) 触电危险!**

只允许专业人员和受过专业训练的人员进行下列工作。

**(ru) Электрический ток! Опасно для жизни!**

Только специалисты или проинструктированные лица могут выполнять следующие операции.

**LZMB(C)2-A(ASF)(S)160(200)(250)**

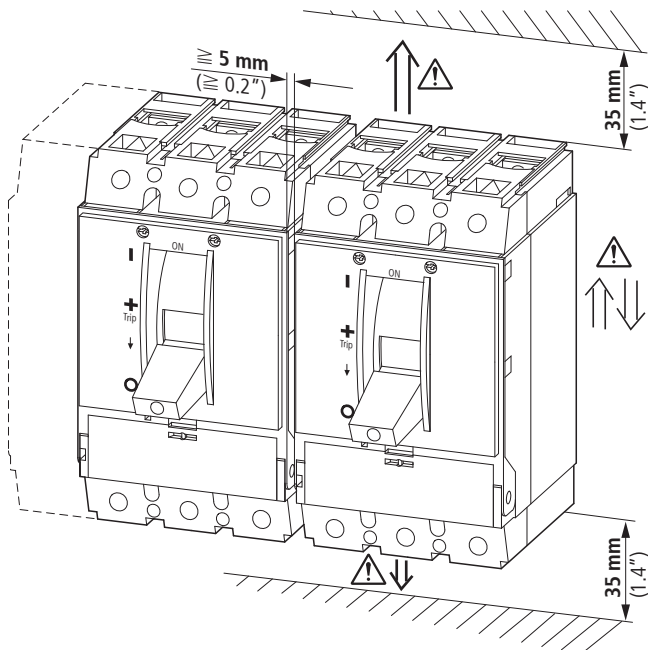

Blowout direction in case of a short-circuit

Ausblasrichtung im Kurzschlussfall

Dégagement gazeux en cas de court-circuit

Dirección de salida de los gases en caso de cortocircuito

Direzione di estinzione in caso di corto circuito

短路时的排空方向

Направление продувки в случае короткого замыкания

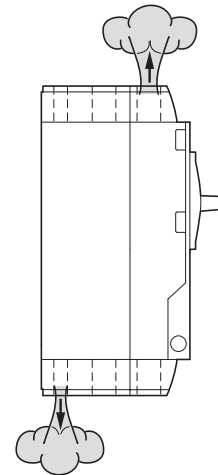

**LZMB(C)2-A(ASF)(S)160(200)(250)**

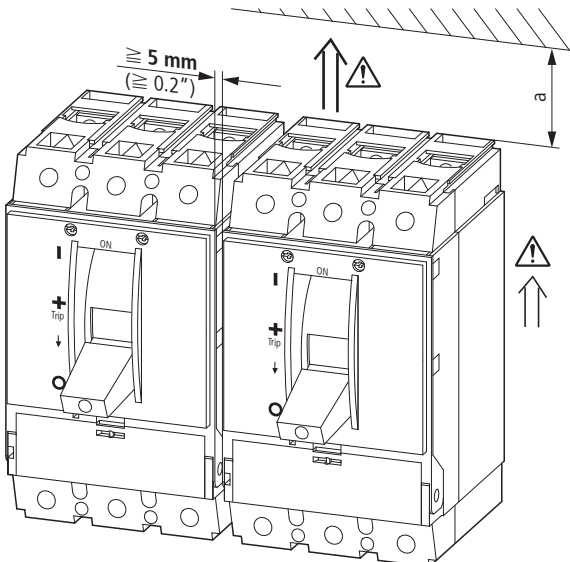

**a = 60 mm**  
(a = 2.36")

Blowout direction in case of a short-circuit

Ausblasrichtung im Kurzschlussfall

Dégagement gazeux en cas de court-circuit.

Dirección de salida de los gases en caso de cortocircuito

Direzione di estinzione in caso di corto circuito

短路时的排空方向

Направление продувки в случае короткого замыкания

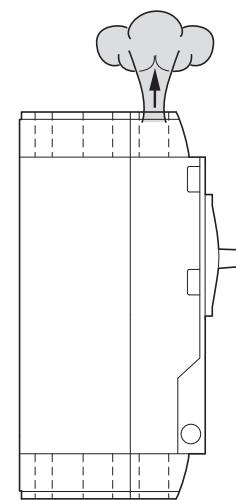

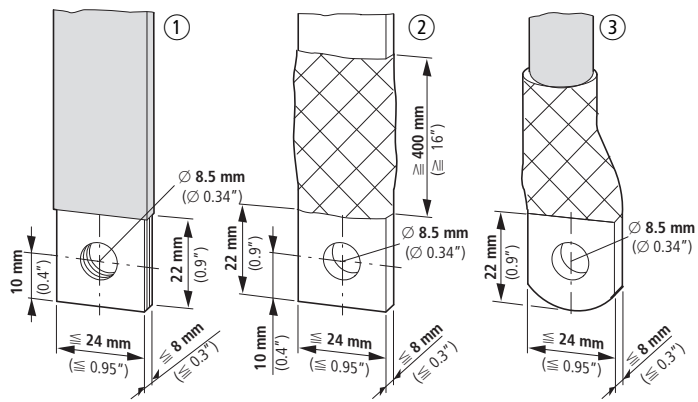

①	②	③
≍ 2 × 9 × 0.8 mm	≍ 16 × 5 mm	1 × 4 – 185 mm <sup>2</sup>
≍ 10 × 16 × 0.8 mm	≍ 20 × 5 mm	2 × 4 – 70 mm <sup>2</sup>
≍ 6 × 24 × 0.5 mm		

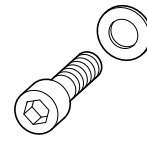

3pol M8 × 22  
4pol



A = 95 mm <sup>2</sup>	KS95-NZM7
A = 120 mm <sup>2</sup>	KS120-NZM7
A = 150 mm <sup>2</sup>	KS150-NZM7
A = 185 mm <sup>2</sup>	NZM2-XKS185



n



n = Number of crimps  
n = Anzahl der Pressungen  
n = Nombre de sertissages  
n = Número de compresiones  
n = Numero delle crimpature  
n = 压制数量  
n = Число прессований

2	KS95-NZM7
2	KS120-NZM7
2	KS150-NZM7
2	NZM2-XKS185

1

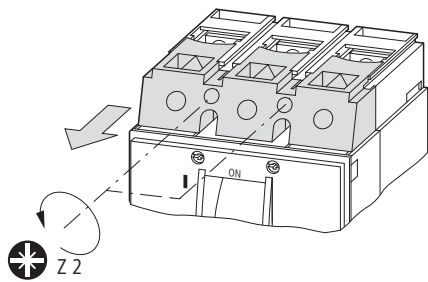

2

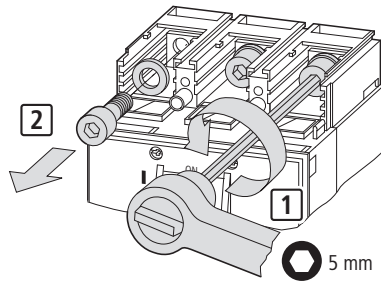

3

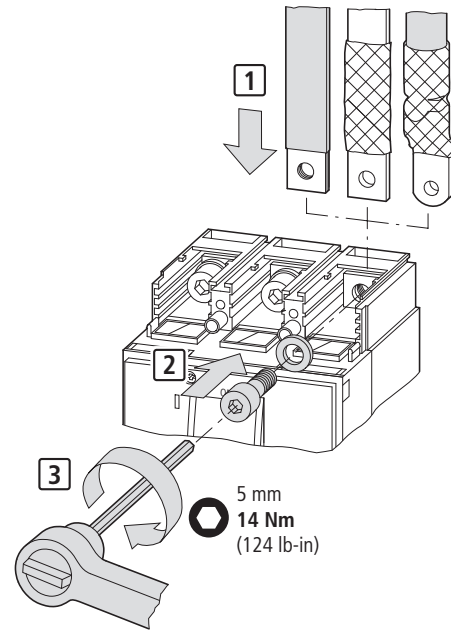

01/11 IL01206012Z

**LZMB(C)2-A(ASF)(S)160(200)(250)**

	XKSA		
≅ 415 V	✓ +	✓	✓
	XKSA		+ XKSA
≅ 525 V	✓ +	✓	✓
	XKSA	XKSA	+ XKSA
> 525 V	✓ +	✓ +	✓

✓ Combination options – Kombinationsmöglichkeiten – Combinaisons possibles – Combinaciones posibles – Combinazioni possibili – 组合方法 – Комбинационные возможности

**LZMB(C)2-A(ASF)(S)160(200)(250)**

01/11 IL01206012Z

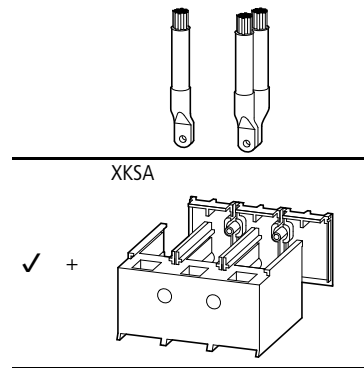

**4**

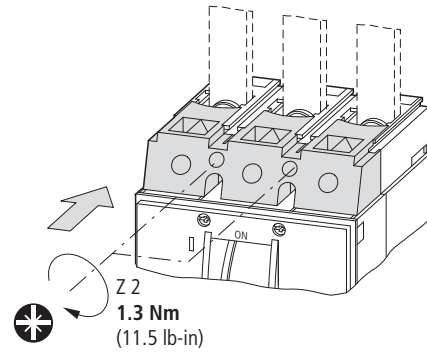

**1**

Settings  
Einstellung  
Réglages  
Parámetros  
Regolazione  
设置  
Настройка

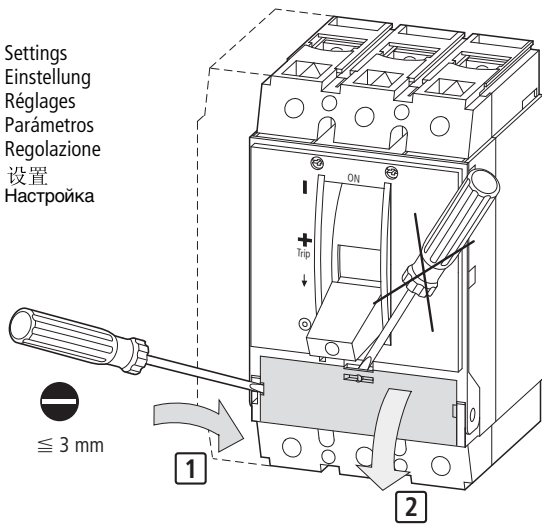

**2**

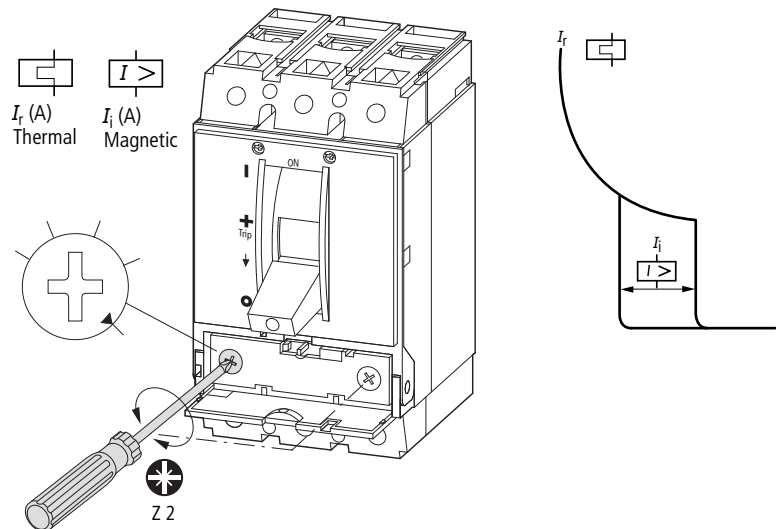

**M22-K10  
M22-K01  
M22-CK10  
M22-CK01  
Auxiliary Switches**

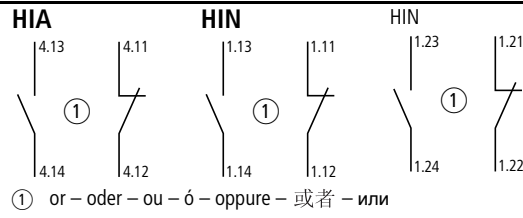

**!**  $I_{th} = I_e$

	$U_e$ (V)	$I_e$ (A)
AC-15	115	4
	230	4
	400	2
	500	1
DC-13	24	3
	42	1.7
	60	1.2
	110	0.8
	220	0.3

**M22-CK11  
M22-CK20  
M22-CK02**

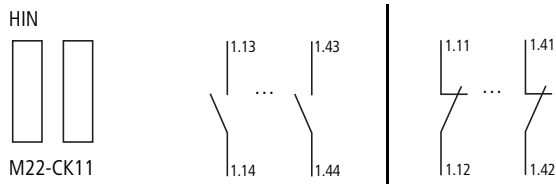
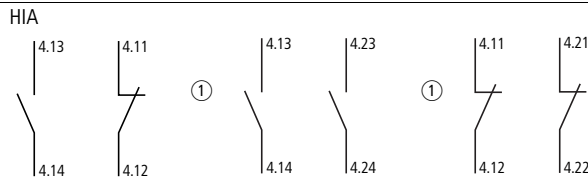

M22-CK11  
①  
M22-CK20  
①  
M22-CK02

Einklappseite: 17 mm Beschnitt

**1**

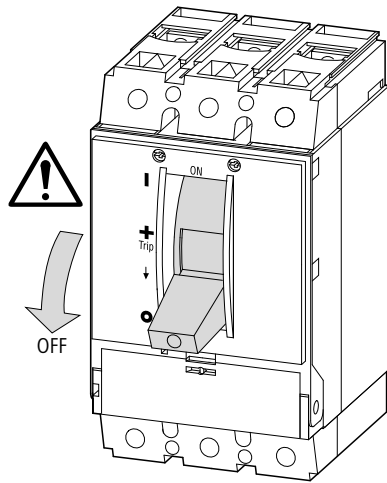

**2**

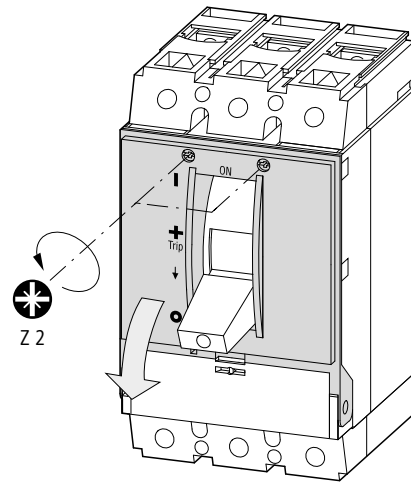

**3**

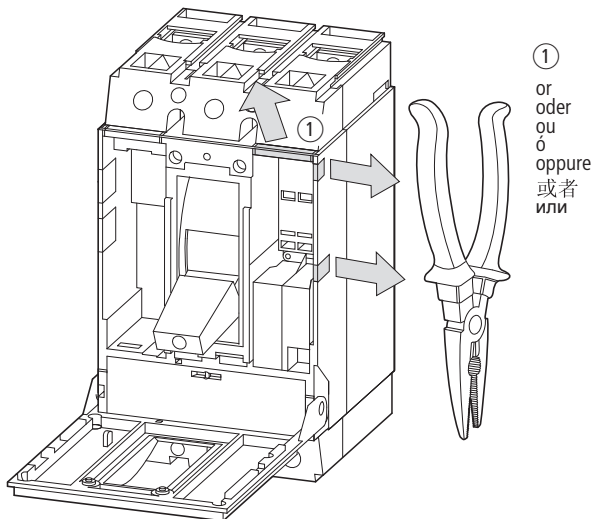

**4**

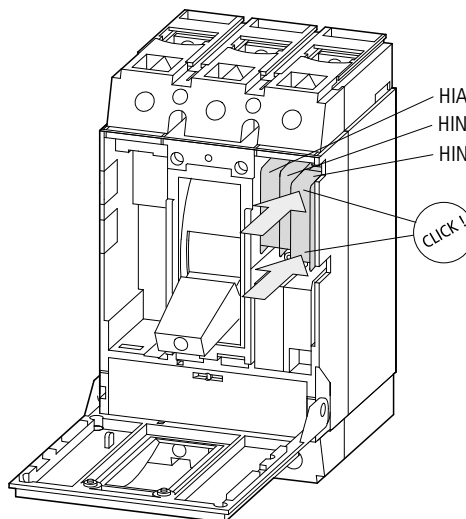

01/11 IL01206012Z

**5a** M22-K10, M22-K01  
(Screw Terminals)

...K10: N. O. Contact  
...K01: N. C. Contact

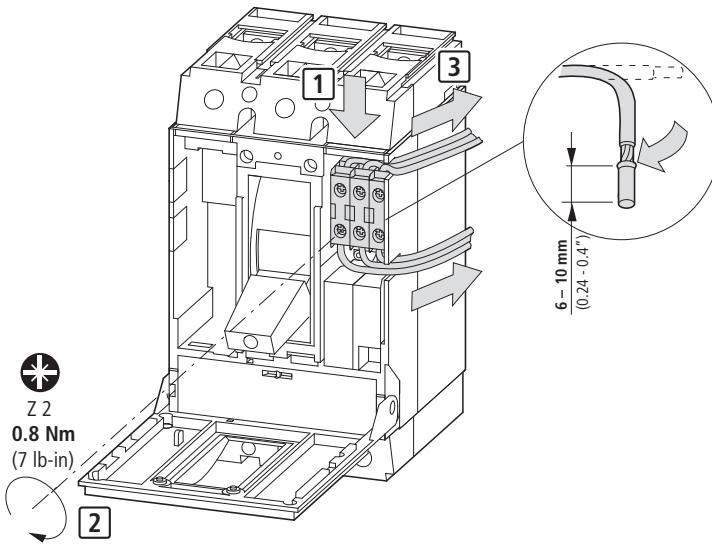
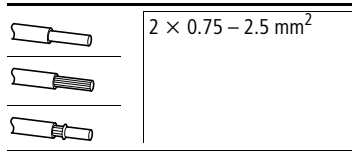

**Z 2**  
**0.8 Nm**  
(7 lb-in)

**5b** M22-CK10, M22-CK01  
(Clamp Terminals)

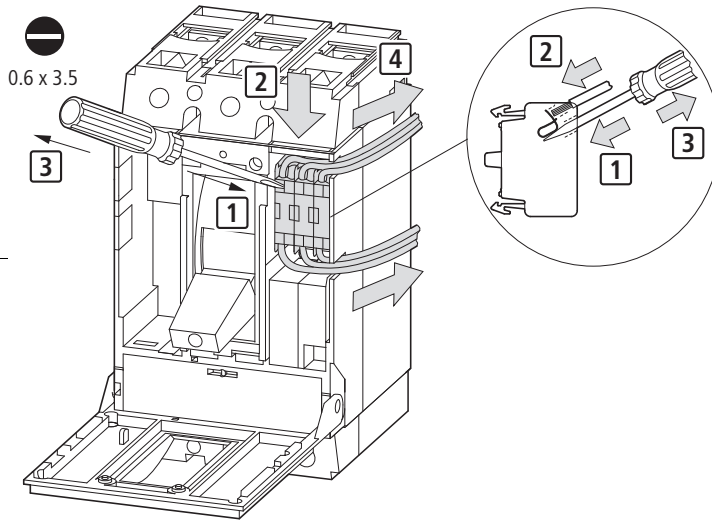
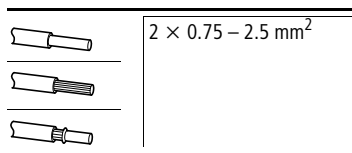

**0.6 x 3.5**

**5c** M22-CK11, M22-CK20, M22-CK02  
(Clamp Terminals)

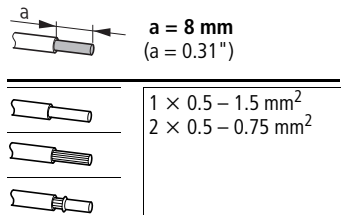

01/11 IL01206012Z

**6**

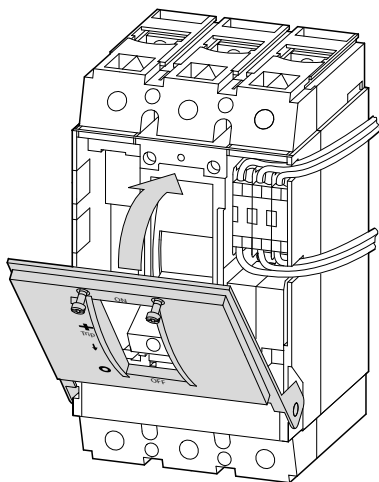

**7**

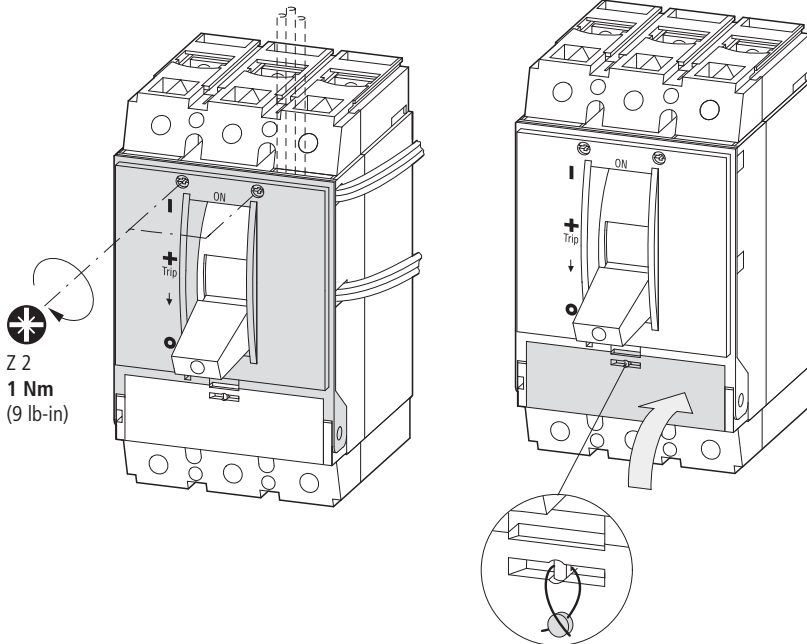

**Z 2**  
**1 Nm**  
(9 lb-in)

Einklappseite: 17 mm Beschnitt

**TEST 1**

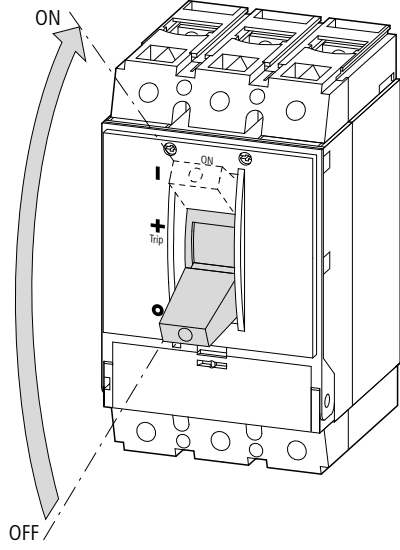

**TEST 2**

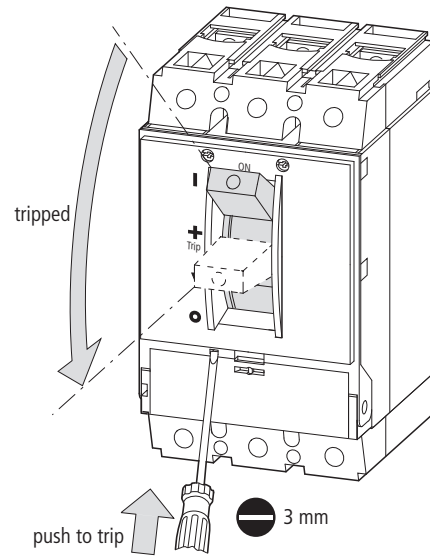

**TEST 3**

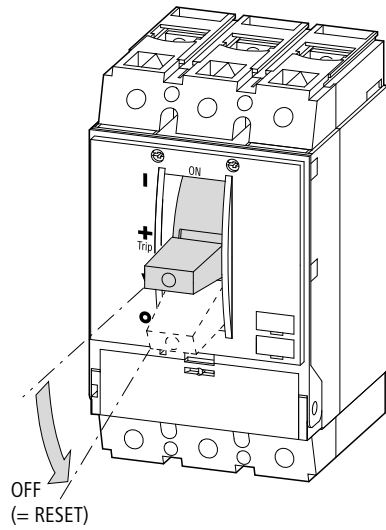

Dismantling  
 Démontage  
 Démontage  
 Desmontaje  
 Smontaggio  
 拆卸  
 Разборка+

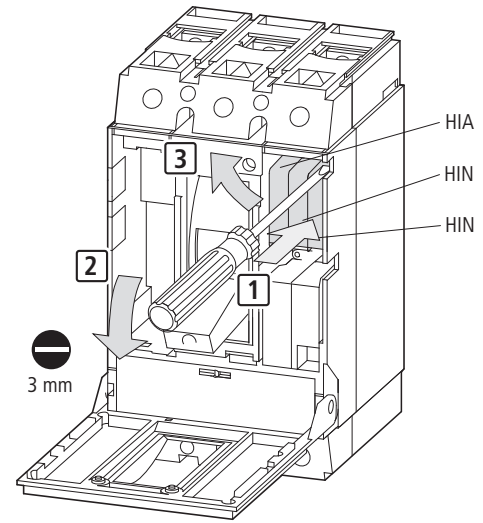

01/11 IL01206012Z

